

- HYDROLOGIC SOIL GROUP A
- HYDROLOGIC SOIL GROUP B
- HYDROLOGIC SOIL GROUP D
- OPEN WATER FEATURE
- IMPERVIOUS COVER

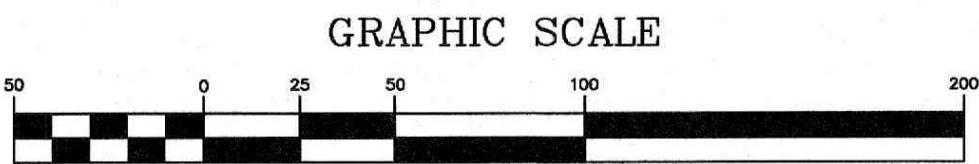

(IN FEET)
1 inch = 50 ft.

DRAINAGE LEGEND:

THE LEGEND BELOW REFLECTS THE HYDROCAD MODEL
USED FOR DRAINAGE CALCULATIONS.

- SSSM SOIL LINES
- 30B DENOTES SOIL TYPE
- P DENOTES POND
- S DENOTES SUBCATCHMENT AREA
- R DENOTES REACH
- L DENOTES POINT OF INTEREST
- LIMIT OF SUBCATCHMENT AREA
- - - - - TIME OF CONCENTRATION

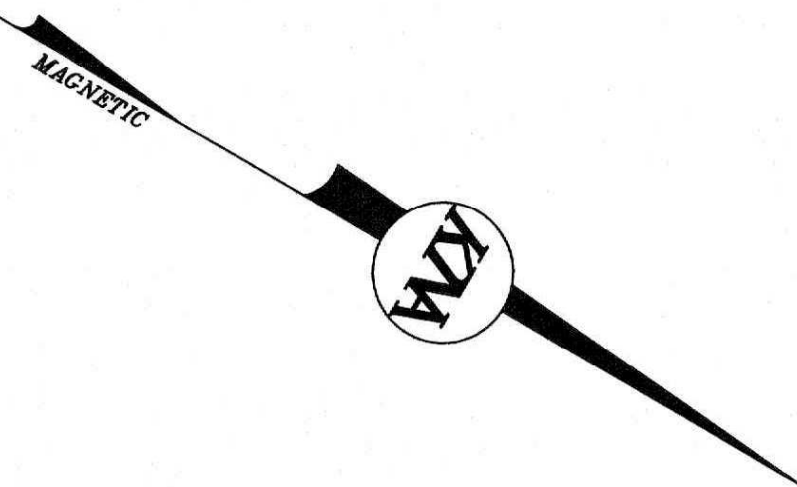

UTILITY NOTE

THE UNDERGROUND UTILITIES DEPICTED HEREON HAVE BEEN DRAWN FROM FIELD SURVEY INFORMATION AND OR PLOTTED FROM EXISTING DRAWINGS. KEACH-NORDSTROM ASSOCIATES, INC. MAKES NO GUARANTEES THAT THE UNDERGROUND UTILITIES DEPICTED COMPRISE ALL SUCH UTILITIES IN THE AREA, EITHER IN SERVICE OR ABANDONED. FURTHER, KEACH-NORDSTROM ASSOCIATES, INC. DOES NOT WARRANT THAT THE UNDERGROUND UTILITIES SHOWN ARE IN THE EXACT LOCATION INDICATED ALTHOUGH THEY ARE LOCATED AS ACCURATELY AS POSSIBLE FROM THE INFORMATION AVAILABLE. KEACH-NORDSTROM ASSOCIATES, INC. HAS NOT PHYSICALLY LOCATED THE UNDERGROUND PORTIONS OF THE UTILITIES.

NPDES NOTE

THIS PROJECT DISTURBS IN EXCESS OF 1-ACRE OF LAND. THEREFORE IT WILL BE REQUIRED TO OBTAIN NATIONAL POLLUTANT DISCHARGE ELIMINATION SYSTEM (NPDES) PERMIT COVERAGE AS ISSUED BY THE ENVIRONMENTAL PROTECTION AGENCY (EPA). THE OWNER/DEVELOPER AND "OPERATOR" (GENERAL CONTRACTOR) SHALL EACH BE REQUIRED TO PREPARE AND SUBMIT A NOTICE OF INTENT (NOI) TO THE EPA PRIOR TO THE START OF CONSTRUCTION AND SHALL BE RESPONSIBLE FOR THE PREPARATION AND IMPLEMENTATION OF A STORM WATER POLLUTION PREVENTION PLAN (SWPPP) MEETING THE REQUIREMENTS OF THE CURRENT CONSTRUCTION GENERAL PERMIT.



PRE-DEVELOPMENT DRAINAREAS PLAN

**JENNESSTOWN MANOR
MAP 7, LOTS 39 & 39-1**

ROUTE 103
WARNER, NEW HAMPSHIRE
MERRIMACK COUNTY

OWNER/APPLICANT:

PEACOCK HILL ROAD, LLC
145 OLD TOWN ROAD
WEARE, NH 03281
BK. 3829 PG. 2512

KEACH-NORDSTROM ASSOCIATES, INC.

Civil Engineering Land Surveying Landscape Architecture
10 Commerce Park North, Suite 3B, Bedford, NH 03110 Phone (603) 627-2881

REVISIONS

No.	DATE	DESCRIPTION	BY
1	5/22/25	PER PB AND AOT COMMENTS	AEW
2	9/4/25	PER AOT COMMENTS	AEW
3	10/2/25	PER AOT COMMENTS	AEW
4	10/31/25	PER ARIES & FIRE COMMENTS	JDL
5	11/18/25	PER AOT & COND. OF APPROVAL	AEW
6	12/16/25	PER AOT COMMENTS	AEW

DATE: MARCH 25, 2025 SCALE: 1" = 50'
PROJECT NO: 24-0307-1 SHEET 1 OF 2

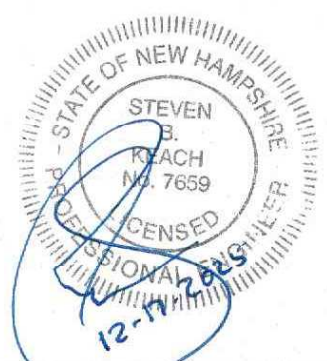

- HYDROLOGIC SOIL GROUP A
- HYDROLOGIC SOIL GROUP B
- HYDROLOGIC SOIL GROUP D
- OPEN WATER FEATURE
- IMPERVIOUS COVER

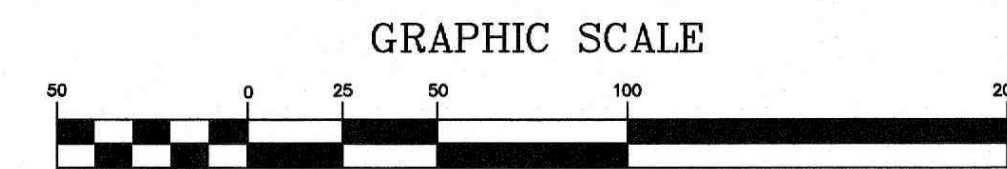

DRAINAGE LEGEND:

THE LEGEND BELOW REFLECTS THE HYDROCAD MODEL USED FOR DRAINAGE CALCULATIONS.

- SSSM SOIL LINES
- 30B DENOTES SOIL TYPE
- P DENOTES POND
- S DENOTES SUBCATCHMENT AREA
- R DENOTES REACH
- L DENOTES POINT OF INTEREST
- LIMIT OF SUBCATCHMENT AREA
- - - - - TIME OF CONCENTRATION

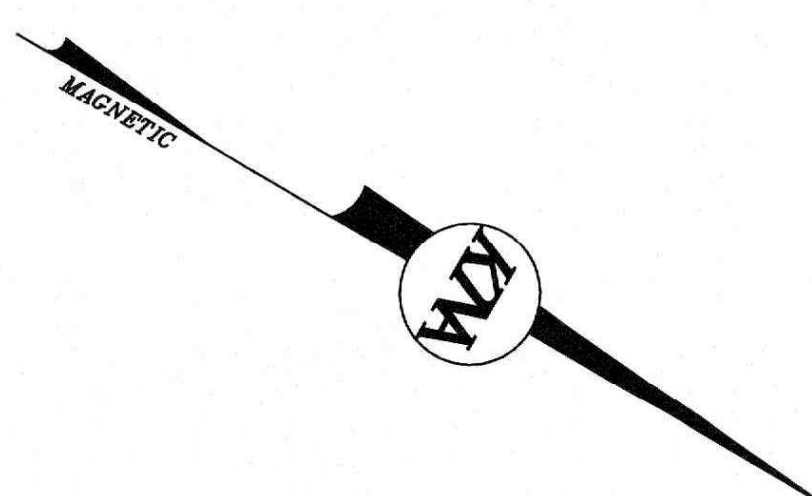

UTILITY NOTE

THE UNDERGROUND UTILITIES DEPICTED HEREON HAVE BEEN DRAWN FROM FIELD SURVEY INFORMATION AND OR PLOTTED FROM EXISTING DRAWINGS. KEACH-NORDSTROM ASSOCIATES, INC. MAKES NO GUARANTEES THAT THE UNDERGROUND UTILITIES DEPICTED COMPRISE ALL SUCH UTILITIES IN THE AREA, EITHER IN SERVICE OR ABANDONED. FURTHER, KEACH-NORDSTROM ASSOCIATES, INC. DOES NOT WARRANT THAT THE UNDERGROUND UTILITIES SHOWN ARE IN THE EXACT LOCATION INDICATED ALTHOUGH THEY ARE LOCATED AS ACCURATELY AS POSSIBLE FROM THE INFORMATION AVAILABLE. KEACH-NORDSTROM ASSOCIATES, INC. HAS NOT PHYSICALLY LOCATED THE UNDERGROUND PORTIONS OF THE UTILITIES.

NPDES NOTE

THIS PROJECT DISTURBS IN EXCESS OF 1-ACRE OF LAND. THEREFORE IT WILL BE REQUIRED TO OBTAIN NATIONAL POLLUTANT DISCHARGE ELIMINATION SYSTEM (NPDES) PERMIT COVERAGE AS ISSUED BY THE ENVIRONMENTAL PROTECTION AGENCY (EPA). THE OWNER/DEVELOPER AND "OPERATOR" (GENERAL CONTRACTOR) SHALL EACH BE REQUIRED TO PREPARE AND SUBMIT A NOTICE OF INTENT (NOI) TO THE EPA PRIOR TO THE START OF CONSTRUCTION AND SHALL BE RESPONSIBLE FOR THE PREPARATION AND IMPLEMENTATION OF A STORM WATER POLLUTION PREVENTION PLAN (SWPPP) MEETING THE REQUIREMENTS OF THE CURRENT CONSTRUCTION GENERAL PERMIT.



POST-DEVELOPMENT DRAINAREAS PLAN

JENNESSTOWN MANOR
MAP 7, LOTS 39 & 39-1

ROUTE 103
WARNER, NEW HAMPSHIRE
MERRIMACK COUNTY

OWNER/APPLICANT:
PEACOCK HILL ROAD, LLC
145 OLD TOWN ROAD
WEARE, NH 03281
BK. 3829 PG. 2512

KEACH-NORDSTROM ASSOCIATES, INC.
Civil Engineering Land Surveying Landscape Architecture
10 Commerce Park North, Suite 3B, Bedford, NH 03110 Phone (603) 627-2881

REVISIONS

No.	DATE	DESCRIPTION	BY
1	5/22/25	PER PB AND AOT COMMENTS	AEW
2	9/4/25	PER AOT COMMENTS	AEW
3	10/2/25	PER AOT COMMENTS	AEW
4	10/31/25	PER ARIES & FIRE COMMENTS	JDL
5	11/18/25	PER AOT & COND. OF APPROVAL	AEW
6	12/16/25	PER AOT COMMENTS	AEW

DATE: MARCH 25, 2025 SCALE: 1" = 50'
PROJECT NO: 24-0307-1 SHEET 2 OF 2

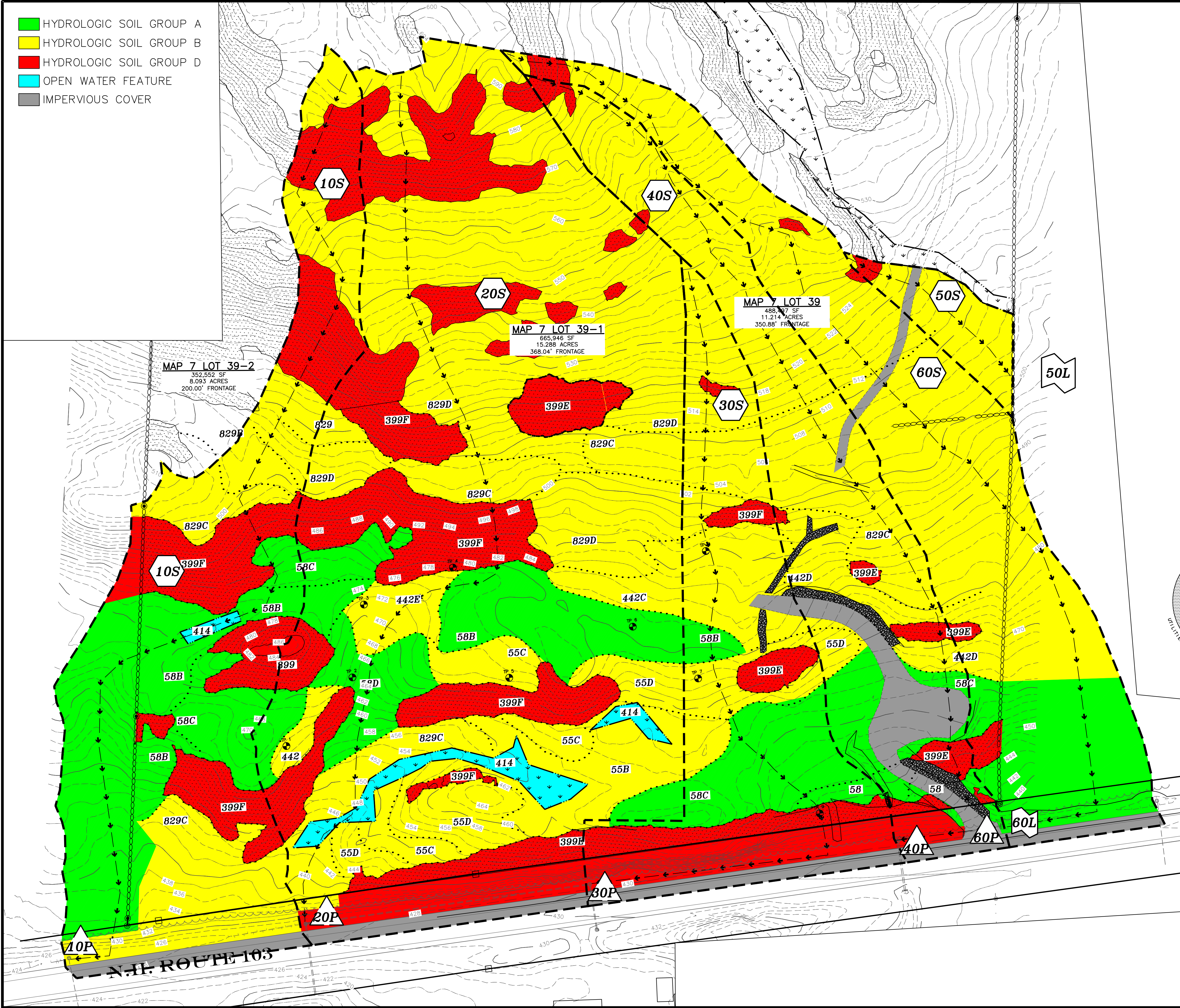

GRAPHIC SCALE

50 0 25 50 100 200

(IN FEET)
1 inch = 50 ft.

DRAINAGE LEGEND:

THE LEGEND BELOW REFLECTS THE HYDROCAD MODEL USED FOR DRAINAGE CALCULATIONS.

- SSSS SOIL LINES
- 30B DENOTES SOIL TYPE
- P DENOTES POND
- S DENOTES SUBCATCHMENT AREA
- R DENOTES REACH
- L DENOTES POINT OF INTEREST
- LIMIT OF SUBCATCHMENT AREA
- - - - - TIME OF CONCENTRATION

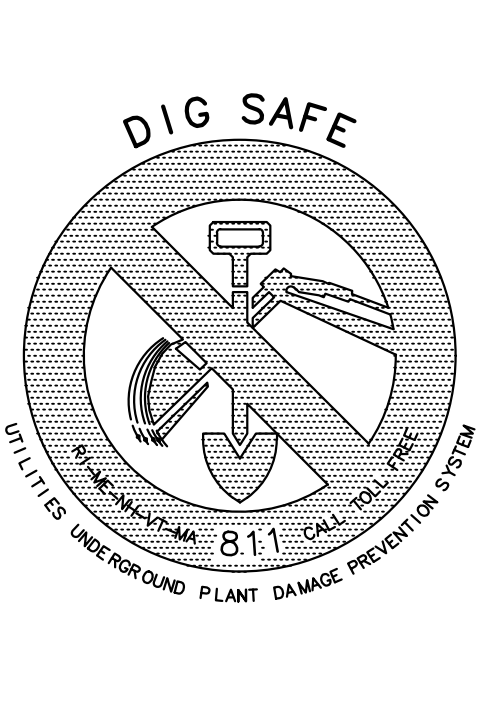
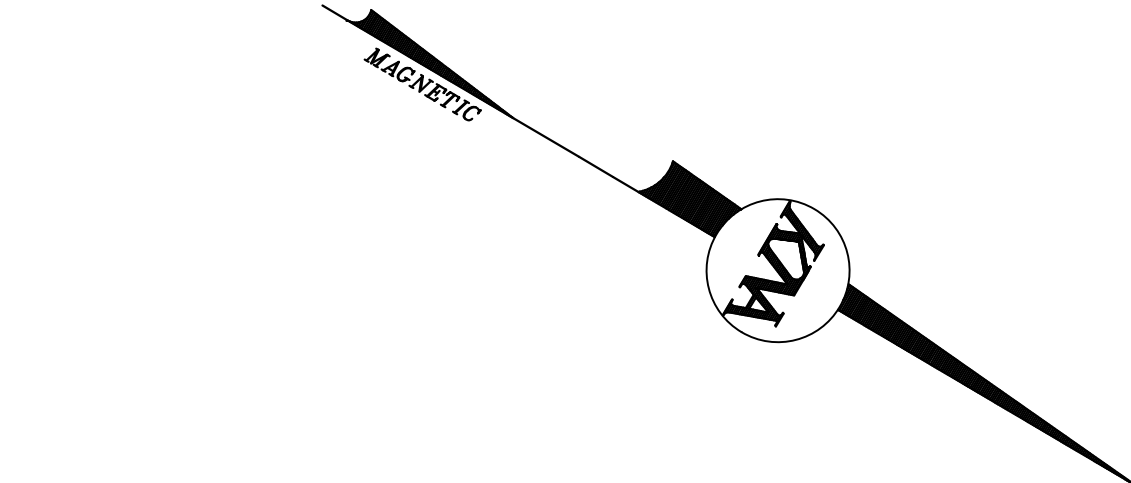

UTILITY NOTE

THE UNDERGROUND UTILITIES DEPICTED HEREON HAVE BEEN DRAWN FROM FIELD SURVEY INFORMATION AND OR PLOTTED FROM EXISTING DRAWINGS. KEACH-NORDSTROM ASSOCIATES, INC. MAKES NO GUARANTEES THAT THE UNDERGROUND UTILITIES DEPICTED COMPRISE ALL SUCH UTILITIES IN THE AREA, EITHER IN SERVICE OR ABANDONED. FURTHER, KEACH-NORDSTROM ASSOCIATES, INC. DOES NOT WARRANT THAT THE UNDERGROUND UTILITIES SHOWN ARE IN THE EXACT LOCATION INDICATED ALTHOUGH THEY ARE LOCATED AS ACCURATELY AS POSSIBLE FROM THE INFORMATION AVAILABLE. KEACH-NORDSTROM ASSOCIATES, INC. HAS NOT PHYSICALLY LOCATED THE UNDERGROUND PORTIONS OF THE UTILITIES.

NPDES NOTE

THIS PROJECT DISTURBS IN EXCESS OF 1-ACRE OF LAND. THEREFORE IT WILL BE REQUIRED TO OBTAIN NATIONAL POLLUTANT DISCHARGE ELIMINATION SYSTEM (NPDES) PERMIT COVERAGE AS ISSUED BY THE ENVIRONMENTAL PROTECTION AGENCY (EPA). THE OWNER/DEVELOPER AND "OPERATOR" (GENERAL CONTRACTOR) SHALL EACH BE REQUIRED TO PREPARE AND SUBMIT A NOTICE OF INTENT (NOI) TO THE EPA PRIOR TO THE START OF CONSTRUCTION AND SHALL BE RESPONSIBLE FOR THE PREPARATION AND IMPLEMENTATION OF A STORM WATER POLLUTION PREVENTION PLAN (SWPPP) MEETING THE REQUIREMENTS OF THE CURRENT CONSTRUCTION GENERAL PERMIT.

PRE-DEVELOPMENT DRAINAREAS PLAN

JENNESSTOWN MANOR
MAP 7, LOTS 39 & 39-1
ROUTE 103
WARNER, NEW HAMPSHIRE
MERRIMACK COUNTY

OWNER/APPLICANT:
PEACOCK HILL ROAD, LLC
145 OLD TOWN ROAD
WEARE, NH 03281
BK. 3629 PG. 2512

KEACH-NORDSTROM ASSOCIATES, INC.
Civil Engineering Land Surveying Landscape Architecture
10 Commerce Park North, Suite 3B, Bedford, NH 03110 Phone (603) 627-2881

REVISIONS			
No.	DATE	DESCRIPTION	BY
1	5/22/25	PER PB AND AOT COMMENTS	AEW
2	9/4/25	PER AOT COMMENTS	AEW
3	10/2/25	PER AOT COMMENTS	AEW
4	10/31/25	PER ARIES & FIRE COMMENTS	JDL
5	11/18/25	PER AOT & COND. OF APPROVAL	AEW
6	12/16/25	PER AOT COMMENTS	AEW

DATE: MARCH 25, 2025 SCALE: 1" = 50'
PROJECT NO: 24-0307-1 SHEET 1 OF 2

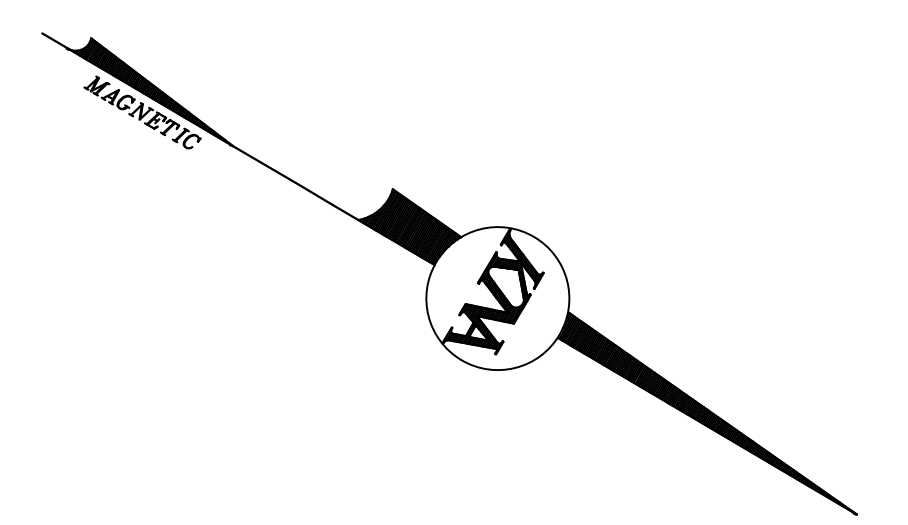
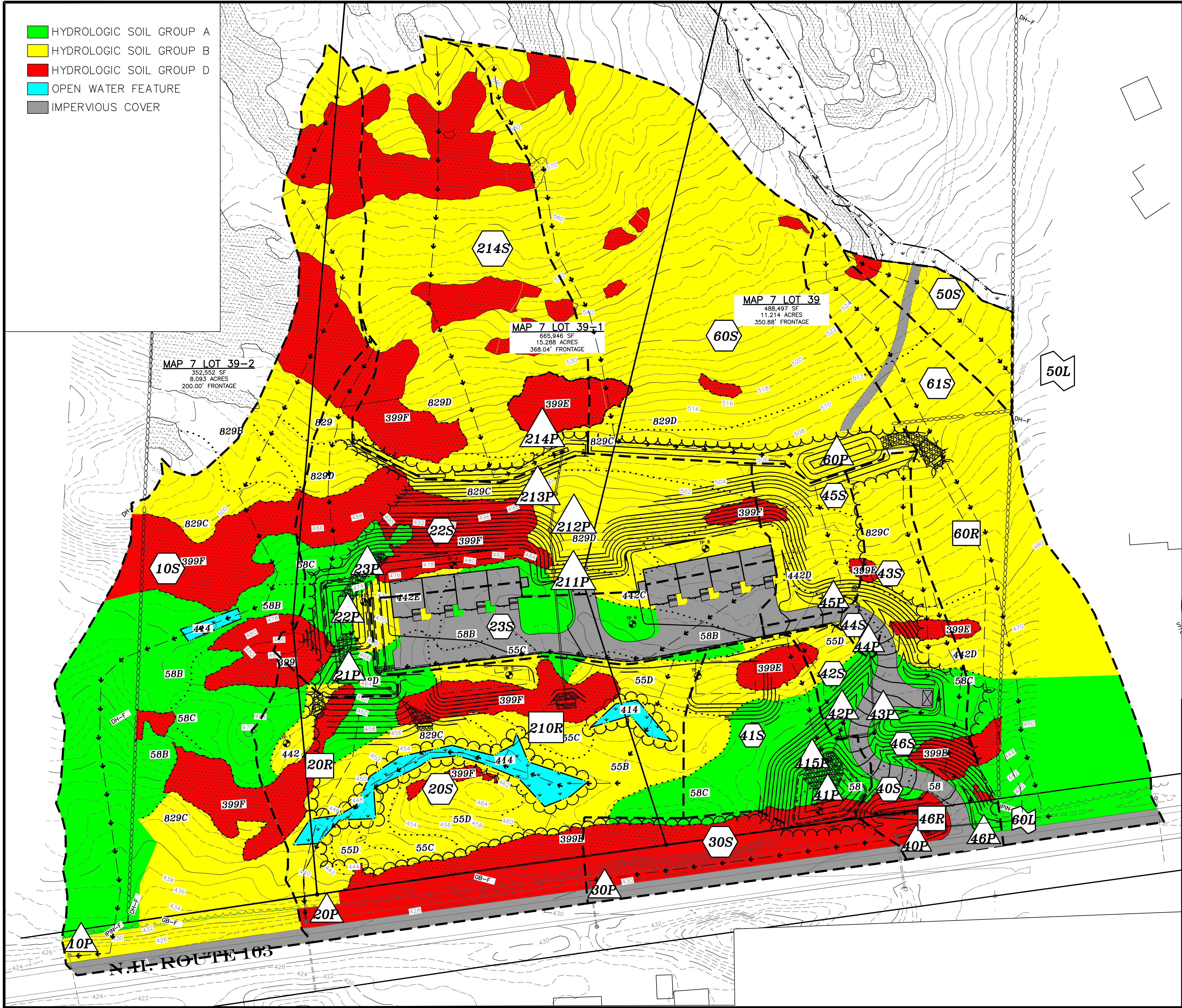

THE UNDERGROUND UTILITIES DEPICTED HEREON HAVE BEEN DRAWN FROM FIELD SURVEY INFORMATION AND OR PLOTTED FROM EXISTING DRAWINGS. KEACH-NORDSTROM ASSOCIATES, INC. MAKES NO GUARANTEES THAT THE UNDERGROUND UTILITIES DEPICTED COMPRISE ALL SUCH UTILITIES IN THE AREA, EITHER IN SERVICE OR ABANDONED. FURTHER, KEACH-NORDSTROM ASSOCIATES, INC. DOES NOT WARRANT THAT THE UNDERGROUND UTILITIES SHOWN ARE IN THE EXACT LOCATION INDICATED ALTHOUGH THEY ARE LOCATED AS ACCURATELY AS POSSIBLE FROM THE INFORMATION AVAILABLE. KEACH-NORDSTROM ASSOCIATES, INC. HAS NOT PHYSICALLY LOCATED THE UNDERGROUND PORTIONS OF THE UTILITIES.

THIS PROJECT DISTURBS IN EXCESS OF 1-ACRE OF LAND. THEREFORE IT WILL BE REQUIRED TO OBTAIN NATIONAL POLLUTANT DISCHARGE ELIMINATION SYSTEM (NPDES) PERMIT COVERAGE AS ISSUED BY THE ENVIRONMENTAL PROTECTION AGENCY (EPA). THE OWNER/DEVELOPER AND "OPERATOR" (GENERAL CONTRACTOR) SHALL EACH BE REQUIRED TO PREPARE AND SUBMIT A NOTICE OF INTENT (NOI) TO THE EPA PRIOR TO THE START OF CONSTRUCTION AND BE RESPONSIBLE FOR THE PREPARATION AND IMPLEMENTATION OF A STORM WATER POLLUTION PREVENTION PLAN (SWPPP) MEETING THE REQUIREMENTS OF THE CURRENT CONSTRUCTION GENERAL PERMIT.

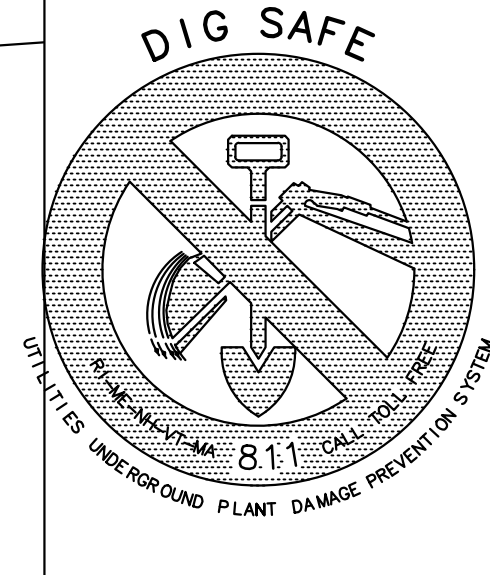

DATE: MARCH 25, 2025	SCALE: 1" = 50'
PROJECT NO: 24-0307-1	SHEET 2 OF 2